



g TP3 xø 3 ôå TPÆMI ?

ART.NR. 116061



INSTRUKCJA INSTALACJI I OBSŁUGI

g TP3 xø 3 ôå TPÆMI ?

EN

1 About this manual

1.1 About the device

The CI 78 control panel communicates with the wireless adapter, which in turn is in wireless communication with the ventilation unit, so that the user can change between the different operating positions on the control panel.

1.2 Admonitions

"Note" is used to highlight additional information.

2 Safety

2.1 Directives

The device meets the following EC directives:

- EMC directive: 2004/108/EC
- Low voltage directive: 2006/95/EC
- RTTE directive: 1999/5/EC
- RoHS directive: 2002/95/EC
- WEEE directive: 2002/96/EC

2.2 Signs on the unit

CE marking of conformity

Use of the device may not be legal in every member state.

Dispose according to European Community Directive 2002/96/EC (WEEE).

2.3 General safety instructions

- The device is designed for indoor use only.
- Do not expose the device to rain or moisture, to avoid short circuit. Short circuit may cause fire or electric shock hazard.
- Operate the device between 0°C and 40°C.
- For cleaning of the device use a soft damp cloth only.
- Never use any abrasive or chemical cleaner.
- Do not paint the device.

3 Installation

3.1 Preparation

Do not place the device in a metal casing.

If not placing on a flush mounted wall box, prepare the wall:

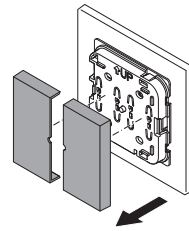

1. Pull the buttons from the unit

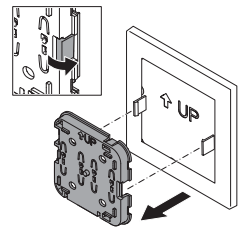

2. Loosen the clips and separate the unit from the mounting plate.

3 If using screws: prepare the wall, if needed. Use the mounting plate as a template.

4 If using tape:

- a. Remove the foil from the double-sided tape.
- b. Make sure that the surface is flat & clean.

3.2 Installation procedure

1 Place device / mounting plate

2 If using screws: fasten the mounting plate using the screws.

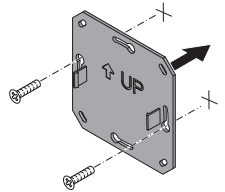

3 Place the device onto the mounting plate. Make sure that "UP" is in the same direction on both the mounting plate and the unit.

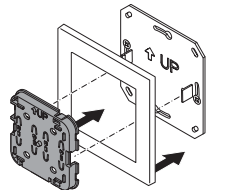

4 Place the buttons.

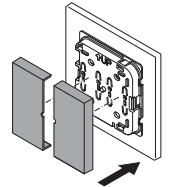

3.3 Commissioning

- A: Away button
- B: Home button
- C: Timer button
- D: Fireplace button
- E: Status LED

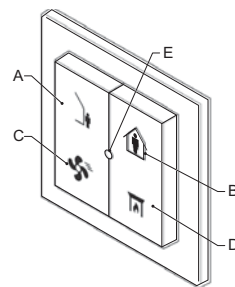

- 1 Prerequisite: Adapter CI 75 must be installed and configured.
- 2 Launch the Flexit GO app on your mobile device and connect to the product.
- 3 When the home screen appears, go to More/Additional functions/Wireless accessories.
- 4 Press **Chosen device** under the heading **Add wireless device**.

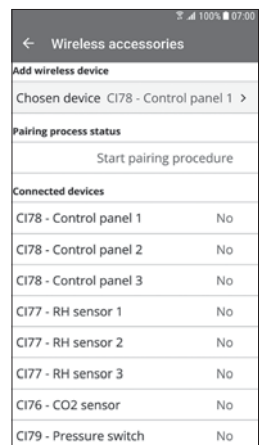

- 5 Then choose **CI 78 Control Panel 1** if you have not installed any previously, otherwise choose the next available no.
- 6 When the **Pairing process status** has switched to **Start pairing procedure** (see image), press and hold down button A and B until the status LED E flashes green. The device is now connected with the product, which is shown in the **Connected devices list** after a few seconds. To add more devices, repeat the process.

4 Description

4.1 Intended use





The device is designed to set the level of ventilation through the fan speed, based on user input.

4.2 Working principle

The button selector on the control panel adjusts to the required fan position. The control panel communicates with the wireless adapter, which in turn is in wireless communication with the air handling unit.

4.2.1 Ventilation speeds and modes

The ventilation system runs in one of the following modes. In each of these modes, the control device sets the ventilation system to a configured level of ventilation.

- AWAY mode:  Intended for use when the building is unoccupied for longer periods.
- HOME mode:  Intended for normal use when the building is occupied.
- Temporary HIGH mode:  Intended for use when a higher ventilation demand is temporarily required.
- Temporary mode:  Intended for temporary use together with a fireplace.

The desired duration time for temporary modes can be set in the Flexit GO App.

4.3 Visual signals

	Status LED	
Startup		
Power up	Orange	1 flash
Status		
OK	Green	
Low battery	Orange	1 flash
Interaction response		
Mode changed	Green	1 flash
Binding succeeded		2 flashes
Communication error	Red	1 flash

5 Operation

1 Press the required button.

The device shows the result on the status LED.

6 Replacing the battery

(See section 3 for more visual instructions)

- 1 Remove the buttons from the unit.
 - 2 Loosen the clips and separate the unit from the mounting plate.
 - 3 Replacing the battery
 - a Remove the old battery.
 - b Place the new battery.
- The LED shortly shows orange.
- 4 Place the device onto the mounting plate.
 - 5 Place the buttons.

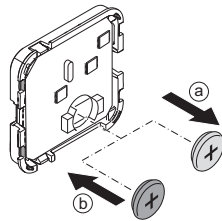

7 Technical data

7.1 Dimensions

Overall dimensions (h x w x d): 84 x 84 x 15 mm
Weight: ± 125g

7.2 Ambient conditions

Operating Temperature Range: 0 to 40 °C
Shipping & Storage Temperature Range: -20 to 55°C
Relative Humidity: 0 - 90%, non-condensing
Ingress protection (IEC60529): IP30

7.3 Battery specification

Type: CR2032

7.4 Wireless connection specifications

Communication frequency: 868.3 MHz
Output power: at least 0 dBm.
You are not allowed to use the device outside of Europe.

Nasze produkty podlegają ciągłemu rozwojowi, dlatego zastrzegamy sobie prawo do wprowadzania zmian. Zrzekamy się również odpowiedzialności za ewentualne błędy w druku.

